

HONG KONG POLYTECHNIC UNIVERSITY



THE HONG KONG
POLYTECHNIC UNIVERSITY
香港理工大學



•Kowloon



HONG KONG

REQUIREMENTS:

- **60 UNITS OR MORE COMPLETED BY DEPARTURE**
- **3.0 GPA. (LOWER GPA WILL BE CONSIDERED)**
- **DECLARED HOSPITALITY MANAGEMENT MAJOR**
- **LANGUAGE OF INSTRUCTION: ENGLISH**
- **STUDENTS WHO ARE CONSIDERED CHINESE NATIONALS ARE NOT ELIGIBLE**
- **SPRING SEMESTER OPTIONS ONLY**

Hong Kong Polytechnic University www.polyu.edu.hk/

The Hong Kong Polytechnic University (Poly U) has a proud and illustrious history dating back to 1937. The university's mission is to provide high quality education of an applied nature in accordance with the changing needs of the society. Poly U is committed to equipping students with professional competency, as well as maintaining a strong partnership with the business and industrial sectors. While exchange students can make friends from all over the world within Poly U's diverse student body, they will be amazed to find how quickly they feel like locals in Hong Kong's friendly and helpful community. The dynamic city life and beautiful countryside are widely appreciated by students at Poly U.

Academic Program

According to three independent surveys, business and industrial leaders rank Poly U graduates and Poly U programs the highest in practical value to employers. Poly U's English learning environment enables overseas students to easily adapt to campus life. In addition, Putonghua, Mandarin, and general education courses enrich students' knowledge about the Chinese language and culture.

Hong Kong, China

Hong Kong is one of the most dynamic and prosperous metropolitan cities of China and indeed, anywhere in the world. Combining 5,000 years of Chinese tradition and around 150 years of western influence, Hong Kong presents you with an ever-changing kaleidoscope of color and culture.

Student Experience Report:

http://www.sfsu.edu/~studyabr/ExperienceReports/Poly_U_Experience_2009.pdf



PROGRAMS FOR:

- **HOSPITALITY AND TOURISM MANAGEMENT MAJORS**

Academic Calendar

Spring Semester: January – Early June

Application Deadlines:

September 15th for Spring Semester

FINANCING YOUR: SEMESTER

<u>FINANCING YOUR:</u>	<u>SEMESTER</u>
SFSU TUITION	\$3138
AIRFARE/TRANS	\$1200
HOUSING	\$700
MEALS	\$1500
BOOKS/SUPPLIES	\$300
INSURANCE	\$250
PERSONAL	\$1000
TOTAL	\$8088

These are estimated costs. Students should plan emergency funds as well.

LAST UPDATED 08/02/2011

The Office of International Programs at SFSU
Village Centennial Square – C
1600 Holloway Ave.
San Francisco, CA 94132
Phone: +1(415) 338-1293 Fax: +1 (415) 338-6234
E-mail: studyabr@sfsu.edu



SF STATE

Study Abroad

<http://www.sfsu.edu/~studyabr/>

HONG KONG POLYTECHNIC UNIVERSITY

Sample Course Offerings

For specific courses and the most current listings, visit:

<http://hotelschool.shtm.polyu.edu.hk/eng/academic/posthk.jsp>

The list below offers a representative sample of the course offerings. For additional courses students should refer to the School of Hotel and Tourism Management section of PolyU's website.

- Hotel and Tourism Management: Attractions Management
- Accounting & Control in Hospitality & Tourism
- Introduction to Hotel Operations
- Service Management
- China Hotel & Tourism
- Consumer Behaviour in Travel & Tourism
- Hospitality & Culture
- Technology Management in Hotel & Tourism
- Hotel/Lodging Management
- Management & Organization
- Hospitality Facilities Management & Design
- Managerial Accounting Practice in Hospitality & Tourism
- Introduction to Foodservice Operations
- Strategic Management for Tourism & Hospitality
- Food Hygiene & Safety Practice
- Businesses Data Analysis
- Food and Beverage Operations
- Human Resources Management in the Tourism & Hotel Industry
- Food & Beverage Management
- Research Methods
- Introduction and Principles of Tourism
- Data Analysis
- Tourism & Transport
- Tourism & Society
- Putonghua for Business & Administration I
- Tourism Business, Ethics & Law
- Tourism Economics
- Tourism & Hospitality Marketing



NEXT STEPS:

1. Visit our website: www.sfsu.edu/~studyabr
2. Come to a Study Abroad Info Meeting
3. Research programs on the web and at OIP
4. **Apply Now!!**
<http://www.sfsu.edu/~studyabr/ApplyNow.html>

SCHOLARSHIP OPPORTUNITIES:

For more information, visit the Scholarships page of our website at:
<http://www.sfsu.edu/~studyabr/scholarships.htm>

Housing:

Housing is arranged by the university in the PolyU Student Halls of Residence. The Student Halls of Residence were completed in 2002 and offer panoramic views of Victoria Harbor and easy transportation throughout Hong Kong.
<http://www.polyu.edu.hk/hall/index.php>

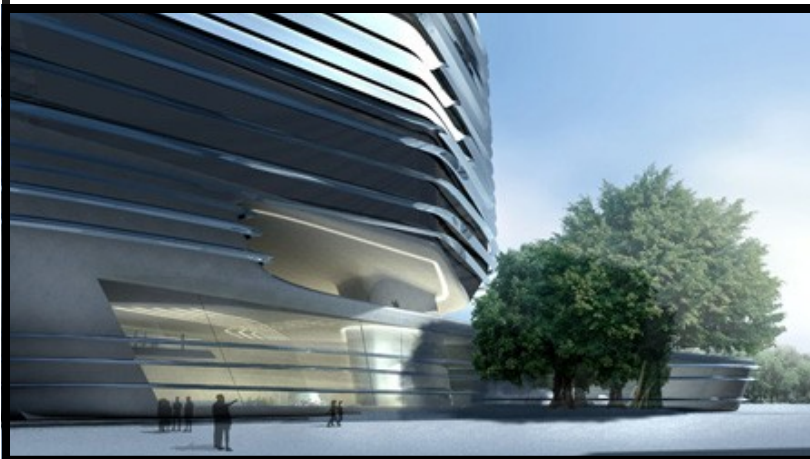

SF STATE

Study Abroad

<http://www.sfsu.edu/~studyabr/>